

Maintenance

Abrasive Containment and Disposal

Empty the abrasive hopper by placing a pail or plastic bag under either of the hopper outlets and open the valve.

Empty the container and repeat as needed.

Warning: Excessive abrasive in the hopper may cause powder to leak through vent holes.



Filter Cleaners

Filter cleaning mallets are located on both sides of the ProCenter Plus. Before each shift, with the power turned off, pull and release the mallets two or three times. This action will dislodge spent media that may have collected in the HEPA filter.

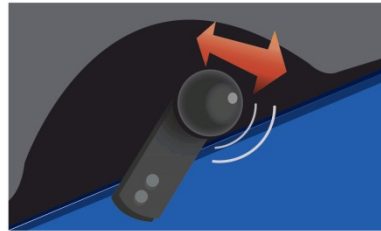

Changing the HEPA Filter

Remove any equipment sitting on top of the filter box.
Disconnect the power cords on both sides of the filter box.
Remove filter box cover.
Remove and replace filter.
(CTR280-1 Replacement HEPA filter assembly)

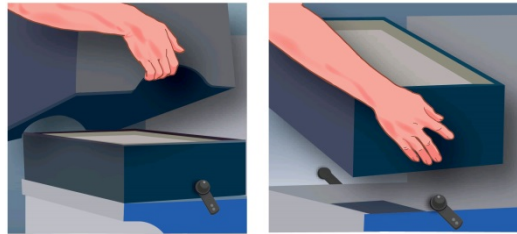

Air Dryer Maintenance

The desiccant inside the air dryer bowl will gradually turn from bright orange to dark green as it becomes saturated. Change according to the instructions included with the air dryer.

For maintenance instructions on your air dryer, please see manual "AD5100 Series – Desiccant Air Dryer."



ProCenter Plus Manual



COMCO

NEED HELP? Comco Tech Support: 800-796-6626
Tech@comcoinc.com www.comcoinc.com

Set-up Guide

Connections

- Feed handpiece from blaster into work chamber
- Attach vent hose to back by slipping Quicknut over hose, working the hose over the nipple, then hand tighten Quicknut onto fitting.
- Connect clear tubing from air dryer to blaster inlet air connector
- Connect black tubing from air dryer to inlet air tee fitting
- Connect shop air using a 1/4" Industrial Shape Quick-Disconnect (customer supplied). *Example: Foster 3 Series SG1513 or McMaster Carr 6536K38*
- Connect power source to ProCenter Plus
- Connect blaster power cord to ProCenter Plus

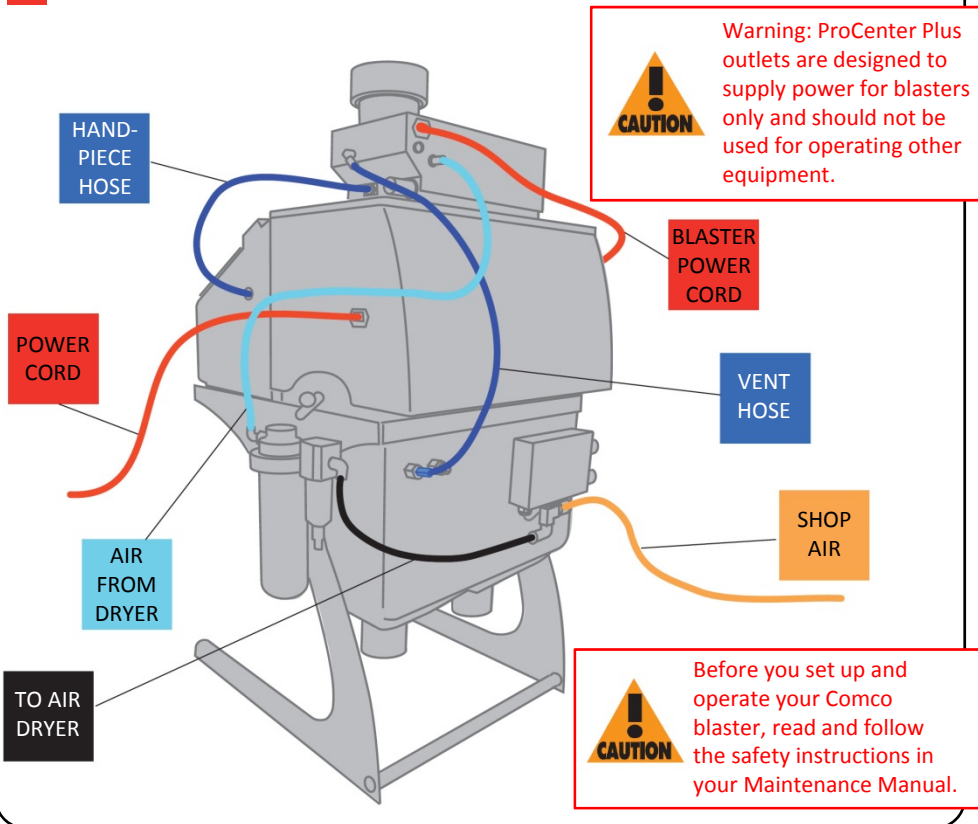
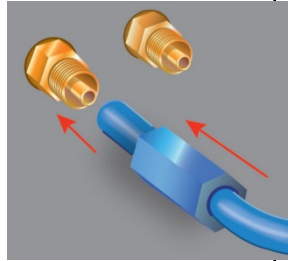

Install Air Dryer

The air dryer unit is preassembled and only requires mounting to the ProCenter Plus and connection of air hoses.

- Locate screw holes and position air dryer on side of ProCenter Plus
- Raise dryer cartridge to facilitate driving screws
- Connect air hoses

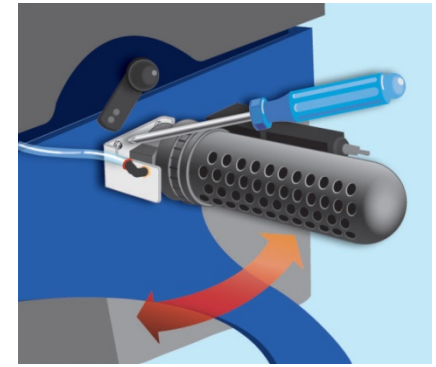

Blow-Off Gun

Clean any powder residue from the part with a quick blast of air.

- Grasp the gun as shown.
- Apply pressure with your thumb to direct a blast of air.



The more the tip is bent, the greater the volume of air released.



Air Pressure Regulators

There are two air regulator controls on the electronics box located on back of the unit.

- Air Purge: regulates flow to the air jets; prevents abrasive from accumulating in front of the work chamber.
Note: There should always be air flowing out of the air jets
- Blow-Off: sets air pressure on the blow-off gun

The air pressure regulators are preset at the factory for reasonable air flow and should not require adjustment with the demands of normal production.

